

叉车门架链轮 (CGxxB1-x) 双列球

Forklift Chain Pulley

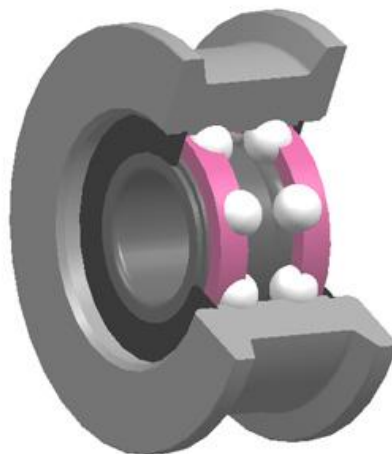
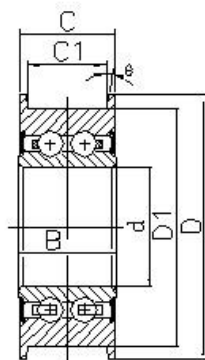

轴承型号	尺寸(mm)	额定载荷(KN)	
	d*D/D1*C/C1*B	Cr	Cor
W256520	25*75/65*30/20*30	20.46	15.87
W258224	25*102/82*40/24*44	20.46	15.87
W2510824	25*128/108*40/24*30	37.94	33.1
W2512629	25*146/126*45/29*30	37.94	33.1
W2510024	25*108/100*35/24*39	58.5	52.8
W285525	28*63/55*30/25*32	13.7	13.0
W308028	30*100/80*42/28*32	30.0	22.86
W309233	30*100/92*45/33*45	39.38	30.41

W3065205	30*73/65*27/20.5*28	29.0	21.0
W3065205	30*73/65*27/20.5*28	30.0	22.0
W308024	30*88/80*32/24*34	28.0	20.0
W3010024	30*108/100*32/24*34	52.8	58.5
W308222	30*97/82*32/22*33.5	35.1	28.5
W359235	35*115/92*45/35*34	40.0	31.1
W359624	35*104/96*34/24*40	38.5	31.0
W35917394	35*100/91.7*47/39.4*49	53.0	38.5
W359033	35*108/90*47/33*49	53.0	38.5
W359624	35*104/96*34/24*40	52.8	58.5
W358027	35*98/80*34/27*36	41.6	30.4
W359021	35*108/90*35/21*37	41.6	30.4
W358022	35*87.5/80*29/22*30	41.6	30.4
W358528	35*96/85*34/28*38	41.6	30.4
W358539	35*115/85*45/39*47	41.6	30.4
W35917394	35*100/91.7*47/39.4*49	52.8	58.5
W358025	35*87/80*31/25*32	26.0	25.0
W407519	40*85/75*26/19*28	20.08	18.7

W408528	40*99/85*36/28*38	35.12	28.92
W4095254267	40*104/95.25*52/42.67*40	40.75	24.01
W4011035	40*122/110*46/35*48	45.5	36.3
W408222	40*97/82*32/22*33.5	35.12	28.92
W407521	40*85/75*26.8/21*28	20.08	18.7
W407519	40*85/75*26/19*28	20.0	19.0
W408528	40*99/85*36/28*38	35.0	29.0
W408033	40*98/80*41/33*43	35.0	29.0
W408019	40*90/80*26/19*28	32.0	25.0
W458026	45*90/80*32/26*32.8	30.0	26.5
W458026	45*88/80*32/26*32.8	30.0	26.5
W4592575	45*106/92.5*46/7.5*47	47.0	38.0
W459125	45*105/91*34/25*30	37.8	33.3
W459533	45*105/95*40/33*41	47.0	38.0
W4595305	45*105/95*38/30.5*41	47.0	38.0
W45107655	45*120/107.6*62/56*66	79.6	60.0
W5011536	50*135/115*52/36*40	54.0	46.45
W5010033	50*112/100*40/33*42	52.66	44.58

W5010536	50*125/105*52/36*40	54.0	46.45
W5010033	50*112/100*40/33*42	52.66	44.58
W5080265	50*88/80*33/26.5*35	23.0	23.0
W5513055	55*158/130*65/55*67	65.75	58.04
W5511045	55*135/110*56/45*58	58.95	51.07
W5511045	55*135/110*56/45*58	58.95	51.07